

Instruction Manual for SK-LTH II α Series Optional Probes for SK-L200TH II α Datalogger

Thank you for purchasing the SK-LTH II α Series Optional Probes for SK-L200TH II α Datalogger.

- This product is designed to measure temperature and humidity by connection with SK-L200TH II α Datalogger. Do not use it for other purposes.
- Read this manual thoroughly before using and keep the manual in a safe place for future reference whenever necessary.

Names of Parts

1. Model SK-LTH II α-1 Probe (plug-in type)

- (1) Sensor
- (2) Sensor unit
- (3) Connector

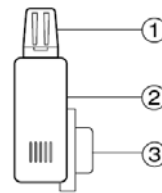

2. Model SK-LTH II α-2 Probe (with sensor cord type)

- (1) Sensor
- (2) Sensor cord
- (3) Sensor unit
- (4) Connector

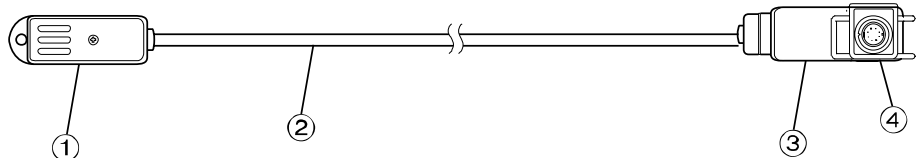

3. Model SK-LTH II α-3 Probe (stick type with sensor cord)

- (1) Sensor
- (2) Sensor cord
- (3) Sensor unit
- (4) Connector

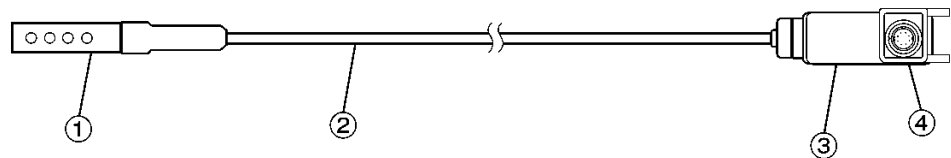

Installing Probes

Install the temperature/humidity probe as follows:

- Push the connector of the probe into the sensor connector of the SK-L200TH II α Datalogger until you hear a “click.”
- To remove the probe, pull it straight out of the sensor connector in the reverse direction of the installation. Never twist the sensor unit when pulling.

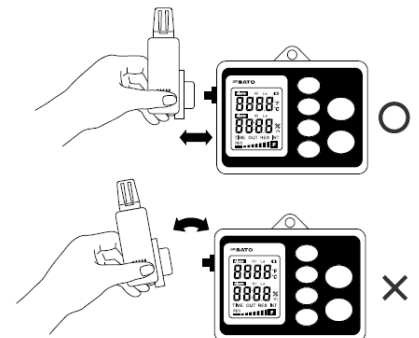

Safety Precautions

To use the probes safely, follow the precautions below.

- Never use the unit in an environment other than standard atmosphere (air composition).
Never touch the humidity sensor with bare hands.
- If the dew point is exceeded and condensation occurs, stop using the sensor immediately and allow time for the sensor to dry naturally at room temperature.
- These probes are not waterproof. Do not let the probes to get wet.

- Never drop the probe or knock it over.
- Measuring temperature and humidity outside the measurable range may cause malfunctions.
- Never disassemble or modify the sensors to avoid any malfunctions.
- Do not modify, forcibly pull, bend or tie the sensor cord. Placing heavy objects on the sensor cord or heating it will also damage the cord.
- Do not immerse the probe into liquid.

For a repair or a calibration, contact us or the retailer from which the Datalogger or probe was purchased.

Specifications

Model	SK-LTH II α-1	SK-LTH II α-2	SK-LTH II α-3
Cat. No.	No. 8176-00	No. 8177-00	No. 8178-00
Sensor (Temp.)	Thermistor		
(Hum.)	High Polymeric Resistance change humidity sensor		
Measuring range (Temp.)	-10.0 to 60.0°C		
(Hum.)	20.0 to 98 % rh (at 23 °C)		
Accuracy (Temp.)	±0.5°C at 20.0 to 30.0°C	±0.5°C at 15.0 to 35.0°C	
	±1°C at other than above	±1°C at other than above	
(Hum.)	Refer to the graphs below		
Materials Sensor unit	ABS resin		
Sensing part	ABS resin		Polyacetal resin
Cord	---	PVC resin	
Dimensions Sensor unit	W 25 x H 70 x D 20 mm		
Sensing part	---	W 18 x H 51 x D 10 mm	Ø8 x L 35 mm
Cord length	---	1.5 m	
Weight	about 15 g	about 65 g	about 69 g
Accessory	Test Result		

Accuracy of R. Humidity

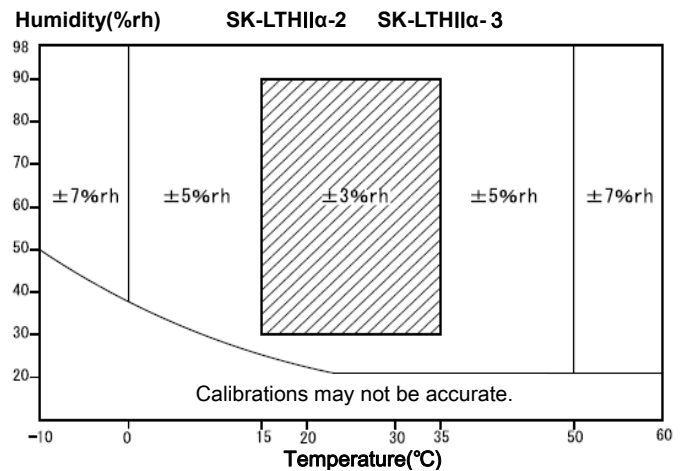
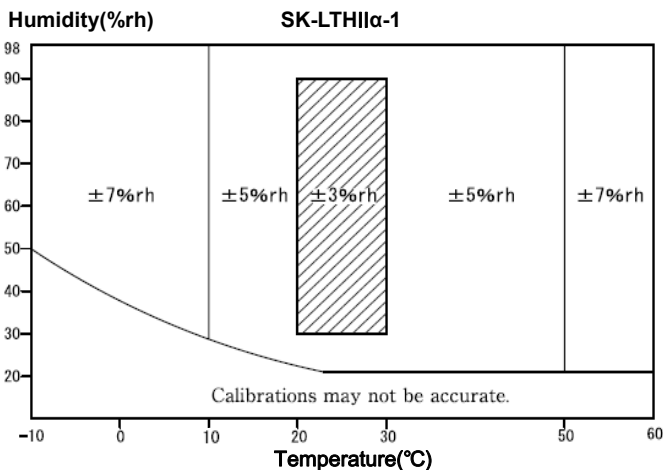

SATO KEIRYOKI MFG. CO., LTD.

No. 3, Nishi Fukudacho, Kanda, Chiyodaku, Tokyo 101-0037 JAPAN
 URL : <http://www.sksato.co.jp/english/>